

ABS Waterfalls

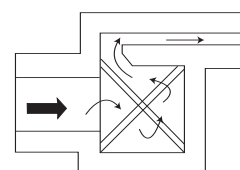
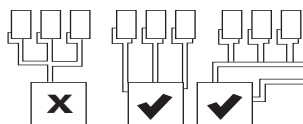
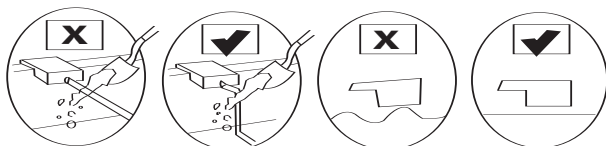
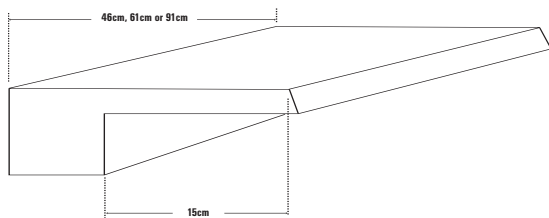

These waterfalls are manufactured in ABS. The patented internal X form gives it an excellent rigidity. Easy installation. Rear connection 1.5" BSP.

Model	Length	Width	Min Flow	Max Tolerance (t)
WFP0001	46cm	15cm	4m ³ /h	8m ³ /h << 12m ³ /h
WFP0002	61cm	15cm	5.5m ³ /h	10m ³ /h << 16m ³ /h
WFP0003	91cm	15cm	8m ³ /h	16m ³ /h << 24m ³ /h

Width may be cut to size to aid installation

These waterfalls can be supplied from the pool circulating pump via a simple connection to the return circuit. Where possible, a valve should be installed to allow the flow in the return lines and the waterfall to be controlled independently. Where this is not possible, then the maximum flow used by the waterfall should not exceed 40% of the pump's total flow, so that the return inlets will still have adequate flow to function correctly.

For waterfall operating simultaneously with return inlets

Filtration Pump	Standard Flow	40% Usable	Waterfall Model and maximum possible quantity to be installed		
			WFP0001	WFP0002	WFP0003
0.75 HP	12 m ³ /h	5 m ³ /h	1	0	0
1 HP	15 m ³ /h	6 m ³ /h	1	1	0
1.5 HP	22 m ³ /h	9 m ³ /h	2	1	1
2 HP	30 m ³ /h	12 m ³ /h	3	2	1
3 HP	35 m ³ /h	14 m ³ /h	3	2	1

Pipe diameter to use

Waterfall flow	Pipe diameter
< 13 m ³ /h	50mm / 1.5"
13 – 22 m ³ /h	63mm / 2"
22 – 31 m ³ /h	75mm / 2.5"
31 – 51m ³ /h	90mm / 3"

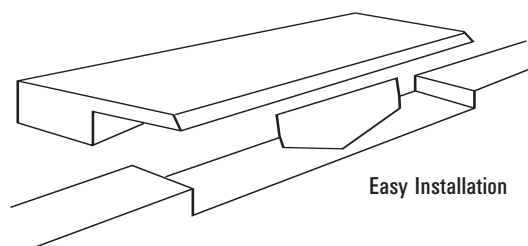

Easy Installation

Installation should be a maximum of 1-1.2m above water level.